

LEVEL 5 - THE OVERVIEW



LEVEL 5



LEVEL 4

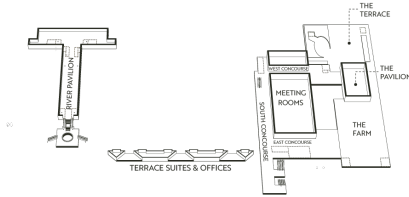

LEVEL 3

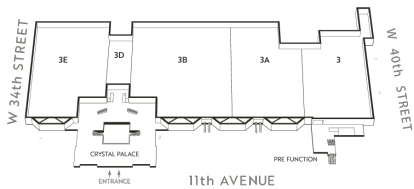

LEVEL 2

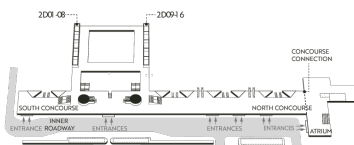

LEVEL 1

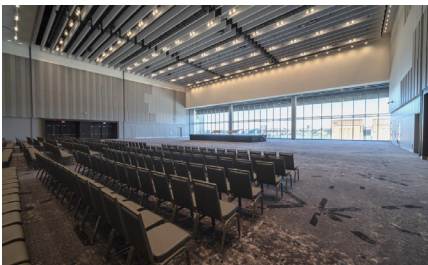
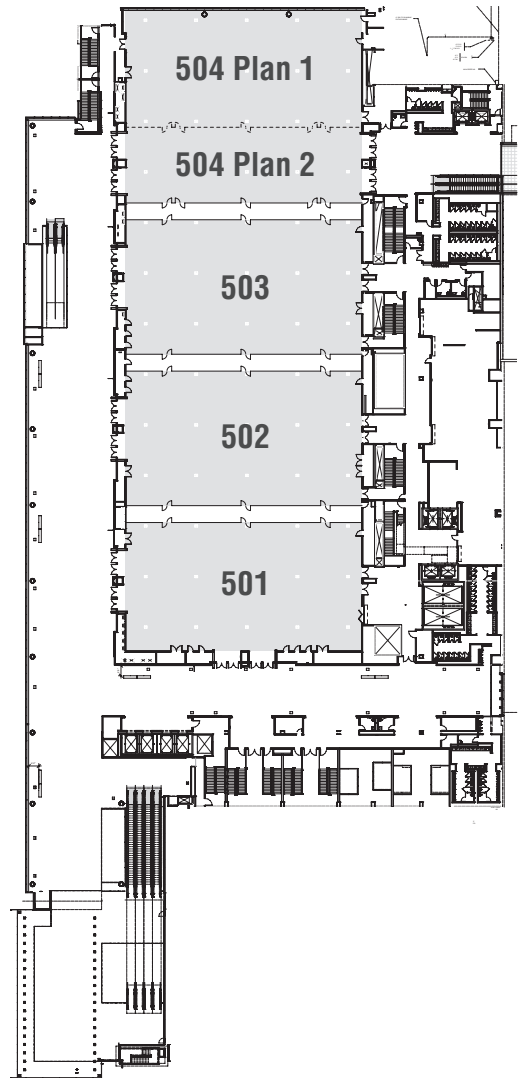
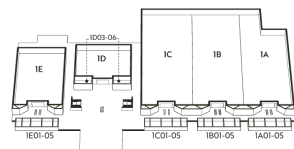

LEVEL 5 SPECIFICATIONS

ROOM	GROSS SQ. FT.	SQ. METERS.	DIMENSIONS (LXW)	CEILING HEIGHT	BANQUET	CLASSROOM	THEATER
The Overview (West Stage Layout)	54,400	5,053	380'-0" x 139'-11"	47'-0"	4,050	3,003	6,540
The Overview (North Stage Layout)	54,400	5,053	380'-0" x 139'-11"	47'-0"	3,950	2,868	6,633
501	11,160	1,036	68'-2" x 139'-11"	47'-0"	620	486	1,234
502	11,406	1,059	79'-8" x 139'-11"	47'-0"	660	528	1,329
503	11,328	1,052	79'-8" x 139'-11"	47'-0"	660	528	1,329
504 (Plan 1)	9,730	903	76'-7" x 139'-11"	47'-0"	630	444	1,145
504 (Plan 2)	16,583	1,540	113'-0" x 139'-11"	47'-0"	1,080	822	1,949
Pre-Function	26,336	2,461	-	20'-0"	-	-	-
Atrium Pre-Function	5,686	531	-	20'-0"	-	-	-

PLEASE NOTE: Audio Visual and other event elements will reduce seating capacities.